

FAG

6203-2RSR

Deep groove ball bearing

Schaeffler ID:
0167195570000Deep groove ball bearing 62...-2RSR,
single row, seals, steel sheet metal cage

Technical information

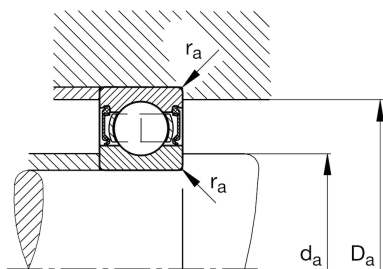
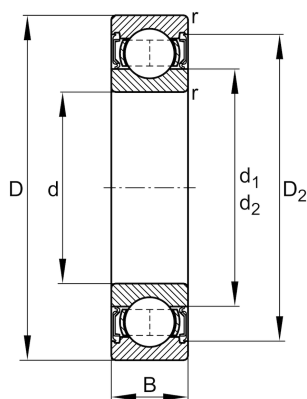
**Main Dimensions & Performance Data**

d	17 mm	Bore diameter
D	40 mm	Outside diameter
B	12 mm	Width
C_r	10.100 N	Basic dynamic load rating, radial
C_{0r}	4.750 N	Basic static load rating, radial
C_{ur}	285 N	Fatigue load limit, radial
n_G	11.100 1/min	Limiting speed
	65,8 g	Weight

Dimensions

r_{min}	0,6 mm	Minimum chamfer dimension
D_2	34,4 mm	Caliber diameter outer ring
d_1	24 mm	Shoulder diameter inner ring

Mounting dimensions

d_{amin}	21,2 mm	Minimum diameter shaft shoulder
D_{amax}	35,8 mm	Maximum diameter of housing shoulder
r_{amax}	0,6 mm	Maximum fillet radius

Calculation factors

f_0	13	Calculation factor
-------	----	--------------------

Temperature range

T_{min}	-20 °C	Operating temperature min.
T_{max}	100 °C	Operating temperature max.